

# Quick Installation Guide

Images may differ from actual products.

## Connect the Hardware

If your internet connection is through an Ethernet cable directly from the wall instead of through a DSL/Cable/Satellite modem, connect the Ethernet cable to the router's Internet port, and then follow Step 4 and 5 to complete the hardware connection.

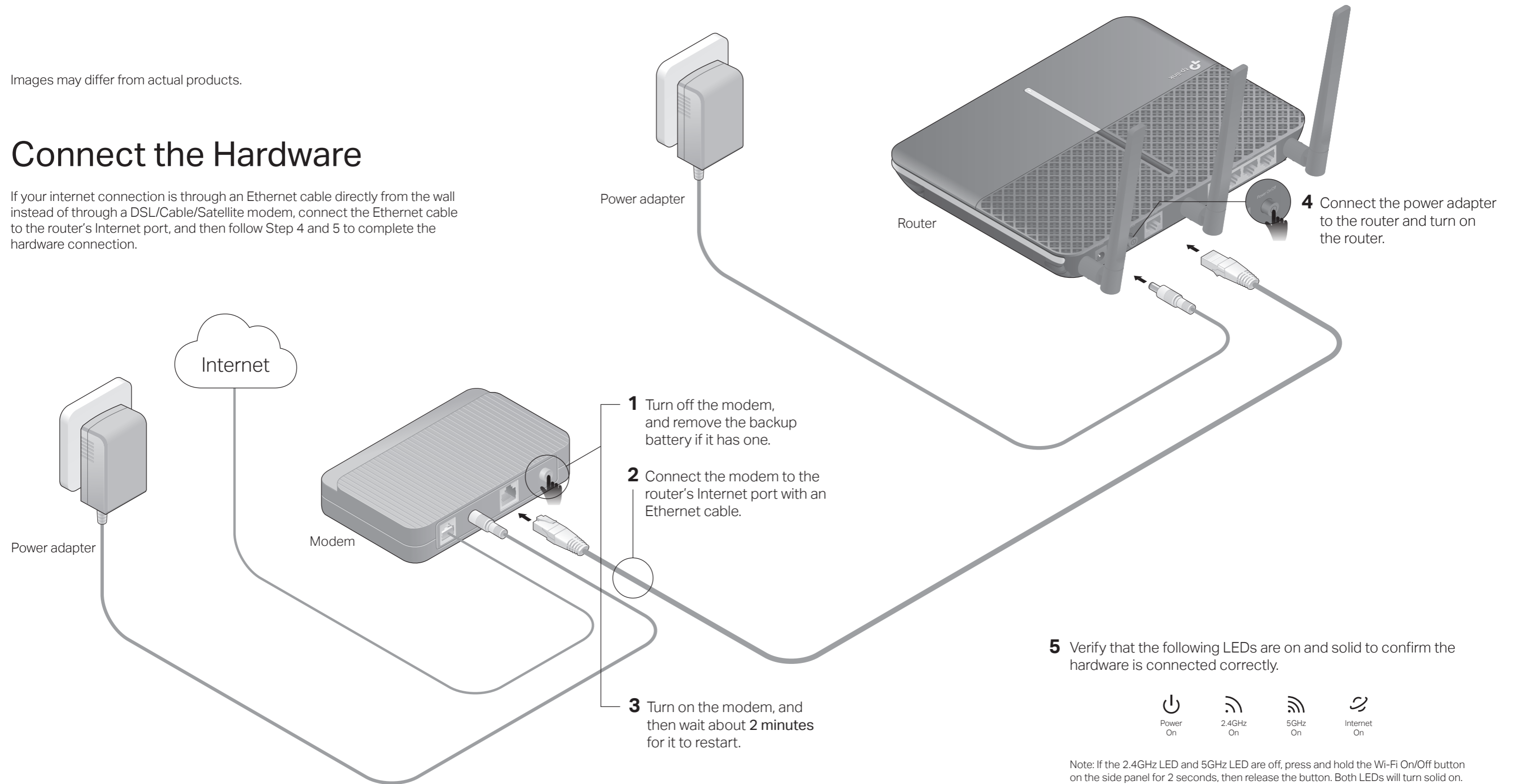

# Configure the Cloud Router

## Method ONE: Via TP-Link Tether App

### 1. Download the Tether app.



### 2. Connect your smartphone to the router.

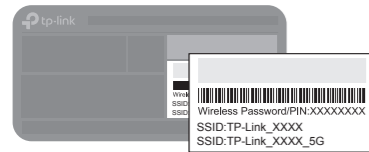

The default wireless network names (SSIDs) and password are printed on the label at the bottom of the router.

### 3. Connect the router to the internet.

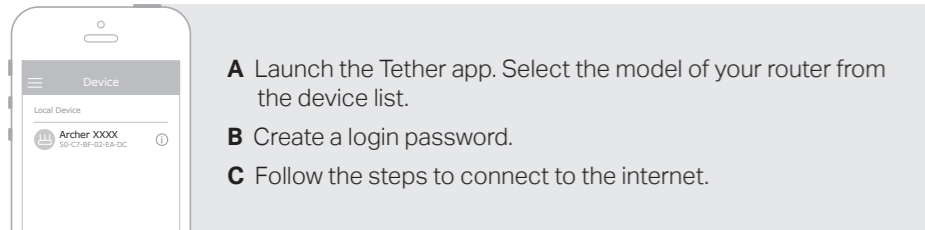

### 4. Register the TP-Link Cloud service.

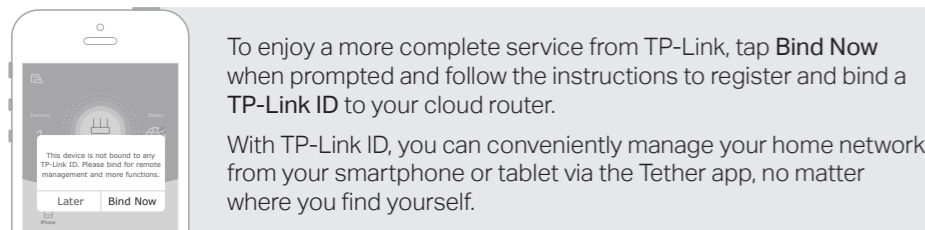

😊 Enjoy the internet !

## Method TWO: Via a Web Browser

### 1. Connect your device to the router (wired or wireless).

#### • Wired

Turn off the Wi-Fi on your computer and connect the devices as shown below.

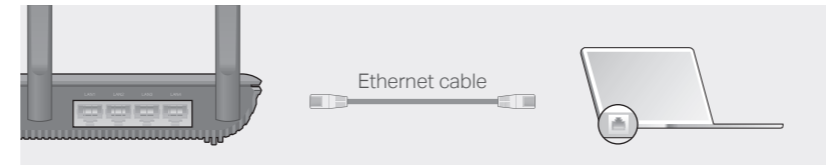

#### • Wireless

- Find the SSID and wireless password printed on the label of the router.
- Click the network icon of your computer or go to Wi-Fi settings of your smart device, and then select the SSID to join the network.

### 2. Connect the router to the internet.

- A** Launch a web browser, and enter <http://tplinkwifi.net> or <http://192.168.0.1> in the address bar. Create a login password for secure management purposes, and then click **Let's Get Started**.

Note: If the login window does not appear, please refer to Q1 of Need Help? in this guide.



- B** Follow the step-by-step instructions to set up an internet connection and register the TP-Link Cloud service.

😊 Enjoy the internet !

# TP-Link Cloud Service

TP-Link Cloud service provides a better way to manage your cloud devices. For example:

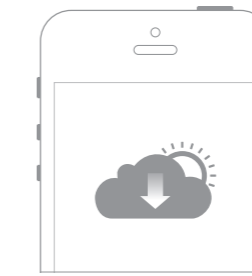

#### Remote Management

Easily manage your home network when you are out and about via the Tether app on your smartphone or tablet.

#### Timely Upgrade Notifications

Keep you informed of the latest firmware updates, ensuring that your router stays at its best.

#### One for All

Manage multiple TP-Link Cloud devices, all from a single TP-Link ID.

You can set up and enjoy cloud functions via the **Tether app** or through the web management page at <http://tplinkwifi.net>.

To learn more about TP-Link Cloud service and other useful features supported by the router (including Guest Network, Parental Controls, Access Control and more), please refer to the User Guide at <http://www.tp-link.com>.

## More Features

The TP-Link router supports various features, including Guest Network, Parental Controls, Access Control and more.

You can log in to the router's web management page at <http://tplinkwifi.net> to apply these functions. For instructions, please refer to the user guide at <http://www.tp-link.com>.

## Support

For technical support, the user guide and more information, please visit <http://www.tp-link.com/support>, or simply scan the QR code.



## Need Help?

### Q1. What should I do if I cannot access the web management page?

- If the computer is set to a static IP address, change its settings to obtain an IP address automatically.
- Verify that <http://tplinkwifi.net> is correctly entered in the web browser. Alternatively, enter <http://192.168.0.1> or <http://192.168.1.1> in the web browser and press Enter.
- Use another web browser and try again.
- Reboot your router and try again.
- Disable then re-enable the network adapter being used.

### Q2. What should I do if I cannot access the internet?

- Check if you have an internet connection by connecting a computer directly to the modem using an Ethernet cable. If you don't, contact your internet service provider.
- Log in to the web management page of the router, and go to the **Basic > Network Map** page to check whether the internet IP address is valid or not. If it is, please run the Quick Setup again; otherwise, recheck the hardware connection.

- For cable modem users, log in to the web management page of the router. Go to **Advanced > Network > Internet > MAC Clone**, click **Use Current Computer MAC Address** and click **Save**, then reboot both the modem and the router.
- Reboot your router and try again.

### Q3. How do I restore the router to its factory default settings?

- While the router is powered on, use a pin to press and hold the **Reset** button on the side panel until all LEDs go off, then release the button.
- Log in to the web management page of the router. Go to **Advanced > System Tools > Backup & Restore**, and click **Factory Restore**. The router will restore and reboot automatically.

### Q4. What should I do if I forget my web management page password?

- If you are using a TP-Link ID to log in, click **Forgot password** on the login page and then follow the instructions to reset the password.

- Alternatively, press and hold the **Reset** button on the side panel until all LEDs go off to reset the router. Wait for the Power LED blinks, and visit <http://tplinkwifi.net> to create a new login password.

### Q5. What should I do if I forget my wireless network password?

- If you haven't changed the default wireless password, it can be found on the product label at the bottom of the router.
- If you have changed the default wireless password, log in to the router's web management page, and go to **Basic > Wireless** to obtain or reset your wireless password.